

BUCKSHAW AVENUE

11/1080

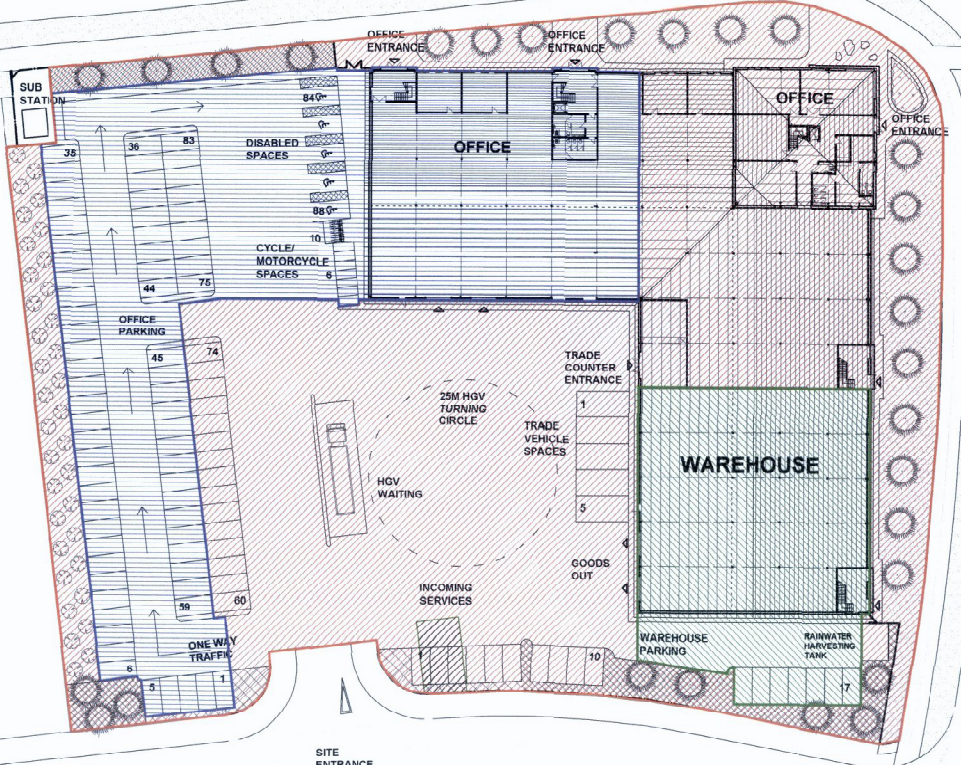

PHASE 1

1292MSQ - INTERNAL
GROUND FLOOR AREA
772MSQ - INTERNAL
FIRST FLOOR AREA

PHASE 2

1076MSQ - INTERNAL
GROUND FLOOR AREA
864MSQ - INTERNAL
FIRST FLOOR AREA

PHASE 3

905MSQ - INTERNAL
GROUND FLOOR AREA
535MSQ - INTERNAL
FIRST FLOOR AREA

CHORLEY COUNCIL
CORPORATE SUPPORT SERVICES
UNION OFFICE SERVICES

REC'D - 9 DEC 2011

FILE
ACKD
ATTEN D

ORDNANCE ROAD

Site layout plan as proposed - PHASING
Scale 1:500 @ A3

BRAMLEY - PATE + PARTNERS
Chartered Architects - Telephone (01772) 335357

LAND OFF BUCKSHAW AVENUE, CHORLEY - Proposed B1/B8 UNIT.	28/11/2011
FOR MR SIMON GOUGH	JOB No. 2615 SK/33/1